



Generator 6 Ft extension cord with Female 30 Amp plug attached to the mounted 30 Amp Male plug [not visible] This is the configuration for driving, or for dry camping.

NOTE: This is a "Do It at a TechRally" Mod that requires the help of an experienced technician in sheet metal, drilling holes in close tolerance locations in bakelite, etc. We suggest you try this modification at one of the TechRallies. If you prefer to make this modification on your own, be sure to route the electrical wires to stay a safe distance from generator exhaust components and contact Ray Wilkes for detailed instructions.

The original modification to make it easier to connect the electrical Shoreline to the campsite power has been improved. This version provides a do-it-yourself 30 amp cord to connect the generator while on the road or dry camping. It retains the ability to connect the Rialta to the campsite power without having to even open the "outback" trunk. It still assures that the campsite power and generator power will never be connected at the same time.

On model year 1997 and later, the shoreline plug may be located under the left skirt of the bumper, so it becomes easier to plug the Rialta into shore power when you have something in the way in the hitch area; this feature was introduced first at the Texas Tech Rally in Feb 2006. Additional new improvements are 30 amp male and female replacement plugs that do not require the electric wires to be spliced but rather connect directly. A revised bracket to mount one of the male plugs on the left bumper skirt is used.

APPROX. MODIFICATION TIME:

2 hours

PART LIST - refer to diagram below

All prices are pre-tax.

See current TechRally Schedule for availability and price of ModKit.

1. Generator output box	n/a
2. 30 Amp bolt together Male Plug, need two	\$7 each
3. 30 Amp three #10 wire cord; 6 ft long	\$5.00
4. 30 Amp bolt together Female Plug, need two	\$11 each
5. Existing power cord, severed by hitch. This section stays with the vehicle.	n/a
6. Existing power cord, severed by hitch. This longer section connects to the camp electric.	n/a
7. Formed Aluminum bracket that fastens to #2, 30 amp Male plug, to inside of left rear bumper	\$2.00
8. Misc support [not shown], instructions, cable ties, solder, tape, etc.	\$2.00
9. Stainless steel and zinc hardware, [not shown]	\$2.00
APPROX. TOTAL COST OF PARTS	\$47.00

(Refer to Part List above.)

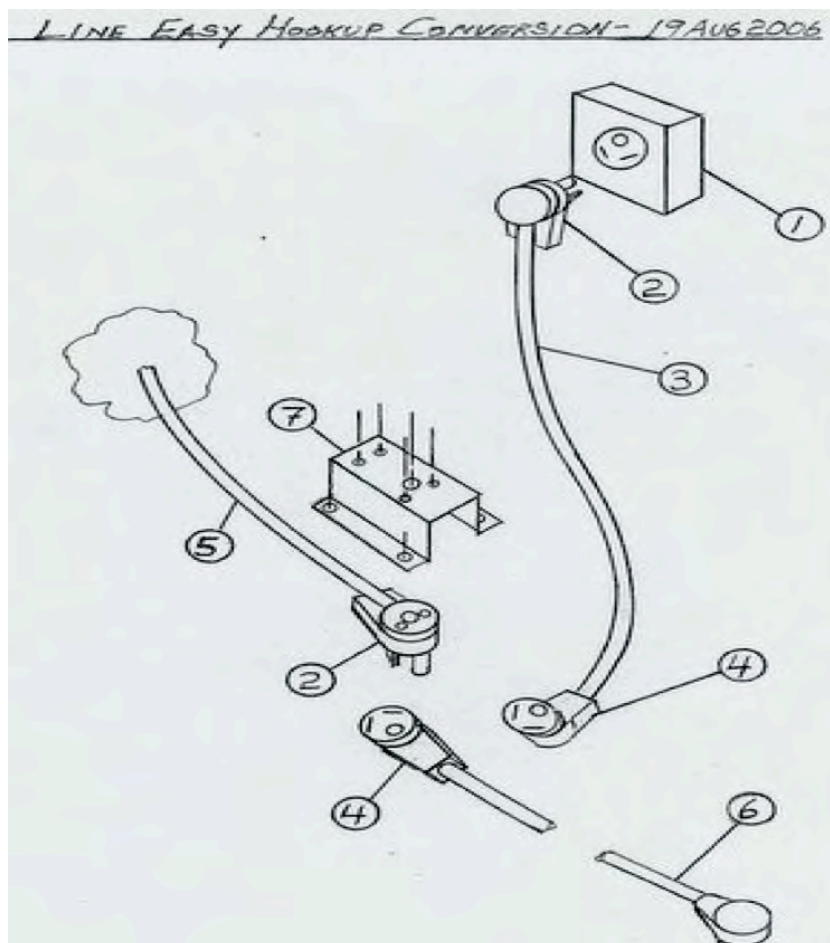



Female 30 Amp plug [that has been fitted to the vehicle end of the severed original shore line cable], attached to the mounted 30 Amp Male plug [not visible]. The 30 Amp cord and Female plug from the generator are hanging down, waiting to be attached when you will leave camp, or for dry camping.



The cord, with it's ends prepared to clamp into the male and female plugs, plus the opened male and female plugs



The female plug open, with the wires attached to the lugs



The female plug closed up and ready to use



The male plug open, with the wires attached to the lugs



The male plug closed and ready to be used

Note: Because neither plug will fit down through the hole in the base of the outback compartment, it is necessary to install the second/final plug with the 3-wire cable strung through this hole.

Updated  
Thursday, 7 September, 2006